

# SMA型コネクタ

## SMA Type Connector

代表形状 Representatives			
接続方式 Connection	ネジ締結 Threaded coupling		
特性インピーダンス Impedance(Ω)	50		
周波数範囲 Frequency Range(GHz)	DC~18.0		
適合ケーブル Applicable Cable	Plug	Jack	Panel Jack
RG-174/U	SMA053		
RG-142A/U	SMA059	SMA259	
RG-142B/U			
RG-141A/U	SMA060		
RG-405/U	SMA135,SMA202	SMA082	SMA088
RG-402/U	SMA174	SMA083	SMA089
コネクタ機能 Connector Type	50Ω		
Receptacle	SMA109, SMA126, SMA128, SMA301☆, SMA302☆, SMA303☆, SMA601, SMA602, SMA606		
Bulkhead Receptacle	SMA106, SMA132, SMA321☆, SMA322☆		
L Type Receptacle	SMA133, SMA603 SMA607, SMA608 SMA311		
L Type Bulkhead Receptacle	SMA114, SMA316☆		
Plug Receptacle	SMA134, SMA331☆		
Adapter (P-P)	SMA136, SMA342☆		
Adapter (J-J)	SMA120, SMA341☆		
Panel Adapter (J-J)	SMA125, SMA344☆		
L Type Adapter (P-J)	SMA613		
Bulkhead Adapter (J-J)	SMA119, SMA343☆		

☆の表面処理はパッシブペイト、それ以外は金メッキになります。  
SMAコネクタには品質保持の為、トルクレンチSST-004をご利用下さい。

**SMA053 / SMA059  
SMA060**

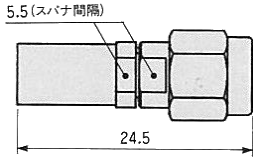

**SMA135 / SMA202**

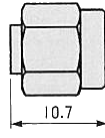

**SMA174**

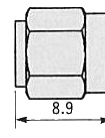

**SMA082 / SMA083**

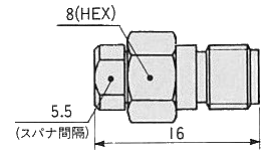

**SMA088 / SMA089**

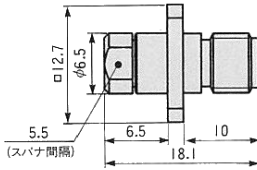

**SMA109 / SMA301 ☆**

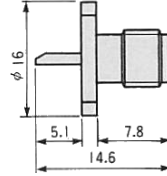

**SMA126 / SMA302 ☆**

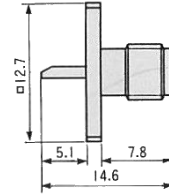

**SMA128 / SMA303 ☆**

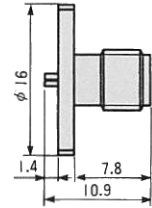

**SMA106 / SMA321 ☆**

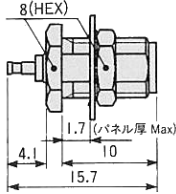

**SMA132 / SMA322 ☆**

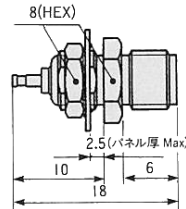

**SMA133 / SMA311 ☆**

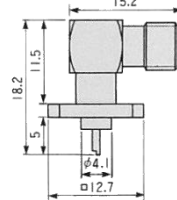

**SMA603 / SMA607  
SMA608**

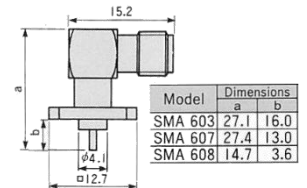

**SMA114 / SMA316 ☆**

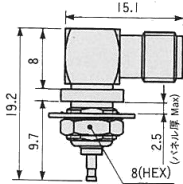

**SMA134 / SMA331 ☆**

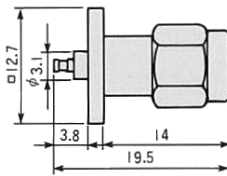

**SMA136 / SMA342 ☆**

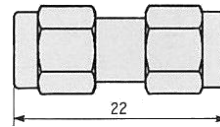

**SMA120 / SMA341 ☆**

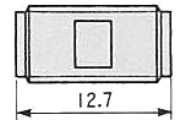

**SMA125 / SMA344 ☆**

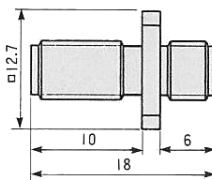

**SMA119 / SMA343 ☆**

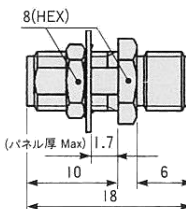

**SMA613**

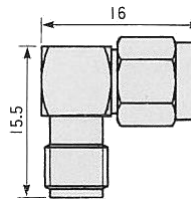

**SMA601**

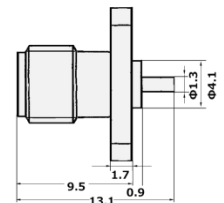

**SMA602**

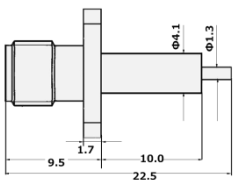

**SMA606**

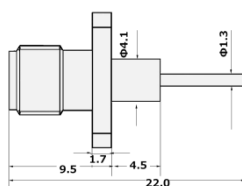

**Mounting Hole**

**SMA088 / sma089**

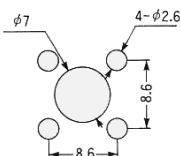

**SMA109 / SMA128  
SMA301 / SMA303**

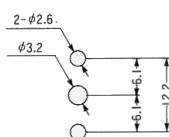

**SMA126 / SMA302**

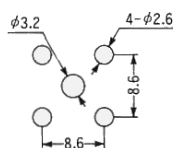

**SMA133 / SMA134  
SMA311 / SMA331  
SMA603 / SMA607  
SMA608**

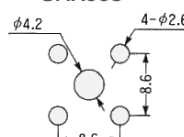

**SMA106 / SMA114  
SMA119 / SMA132  
SMA321 / SMA322  
SMA343**

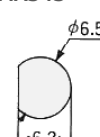

**SMA125 / SMA344**

