

SS(SSMA)型コネクタ

SS(SSMA) Type Connector

代表形状 Representatives			
接続方式 Connection	ネジ締結 Threaded coupling		
特性インピーダンス Impedance(Ω)	50		
周波数範囲 Frequency Range(GHz)	DC~8.0		

適合ケーブル Applicable Cable	Plug	L Type Plug	Bulkhead Jack
1.5D-2V	SS001	SS003	SS010
1.5D-2W	SS002	SS004	SS014
RG-405/U	SS018	SS023	

コネクタ機能 Connector Type	50 Ω
Receptacle	SS005, SS017, SS022
Bulkhead Receptacle	SS007, SS008, SS013
L Type Receptacle	SS006, SS015
L Type Bulkhead Receptacle	SS009
Adapter (P-P)	SS011
Adapter (J-J)	SS012
Bulkhead Adapter (J-J)	SS016

*Plug/(Bulkhead Jack)コネクタをケーブルに取り付ける時には、必ず専用の圧着工具SST-001を使用してください。

*When Plug/(Bulkhead Jack) are connected to the cable, please use the hand crimping tool.

	名称 Product #
SSコネクタ 圧着工具 SS Hand crimping Tool	SST-001

SS001 / SS002

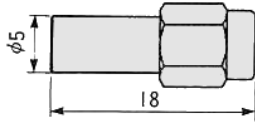

SS003 / SS004

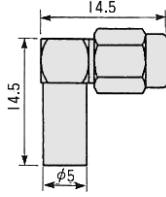

SS005

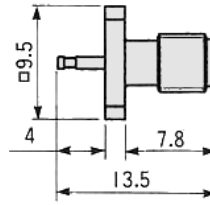

SS006

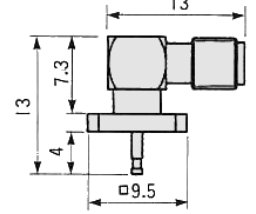

SS007

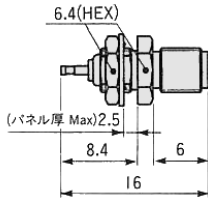

SS008

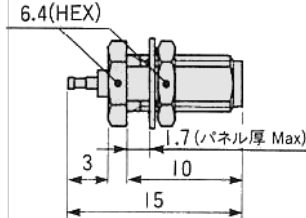

SS009

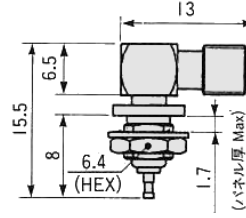

SS010 / SS014

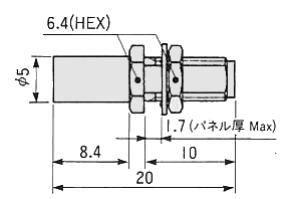

SS011

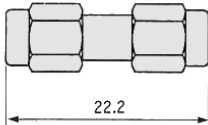

SS012

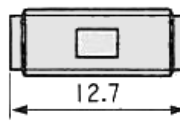

SS013

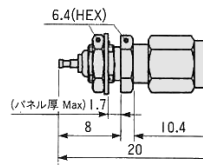

SS015

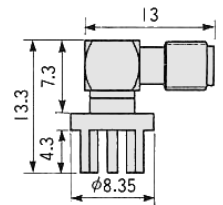

SS016

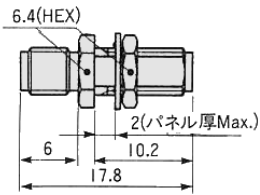

SS017

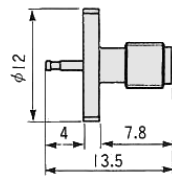

SS018

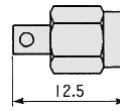

SS022

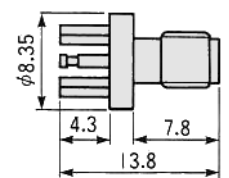

SS023

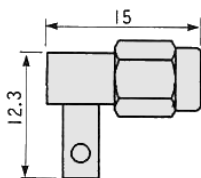

Mounting Hole

SS005 / SS006

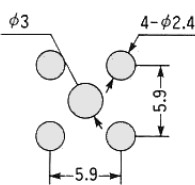

SS015 / SS022

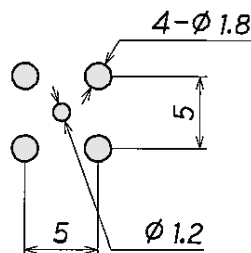

SS017

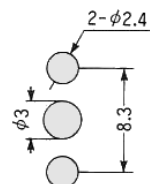

SS007 / SS008
SS009 / SS010
SS013 / SS014
SS016

